

LM-HN TYPE

※ Nut Type

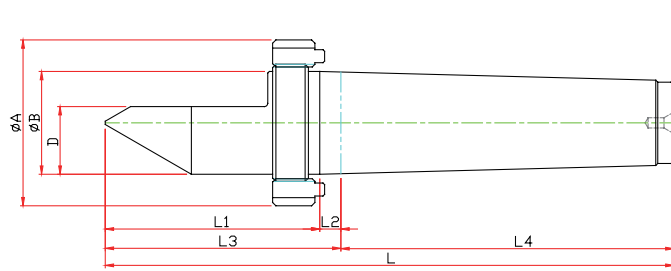

unit:mm/kg

Model	Morse Taper	Dimension										Run out (inch)
		GL	A	L1	L2	L3	L4	D	E	N	L	
LM-1HN	NO.1	12.065	12	31.5	5	36.5	53.5	7.6	22	M16	90	0.00011811
LM-2HN	NO.2	17.780	18	41.5	6.5	48	64	11	30	M22	112	0.00011811
LM-3HN	NO.3	23.825	24	49.5	7.5	57	81	15	38	M27	138	0.00011811
LM-4HN	NO.4	31.267	32	62.5	10	72.5	102.5	21	50	M36	175	0.00011811
LM-5HN	NO.5	44.399	45	77	11	88	129.5	29.4	63	M48	217.5	0.00011811
LM-6HN	NO.6	63.348	64	96.5	11.5	108	182	42	79	M68	290	0.00019685

※SPECIAL sizes or dimensions are available with quick turnaround

LM-HCN TYPE

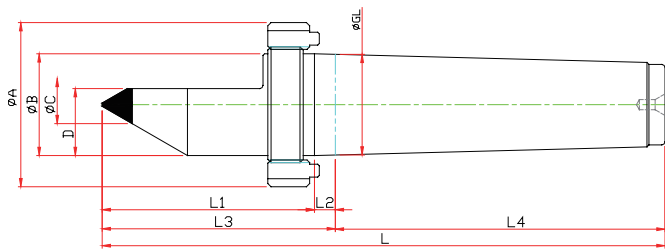

unit:mm/kg

Model	Morse Taper	Dimension											Run out (inch)
		GL	A	L1	L2	L3	L4	C	D	E	N	L	
LM-1HCN	NO.1	12.065	12	31.5	5	36.5	53.5	7	7.6	22	M16	90	0.00011811
LM-2HCN	NO.2	17.780	18	41.5	6.5	48	64	7	11	30	M22	112	0.00011811
LM-3HCN	NO.3	23.825	24	49.5	7.5	57	81	10	15	38	M27	138	0.00011811
LM-4HCN	NO.4	31.267	32	62.5	10	72.5	102.5	14	21	50	M36	175	0.00011811
LM-5HCN	NO.5	44.399	45	77	11	88	129.5	18	29.4	63	M48	217.5	0.00011811
LM-6HCN	NO.6	63.348	64	96.5	11.5	108	182	18	42	79	M68	290	0.00019685

※SPECIAL sizes or dimensions are available with quick turnaround

LM-H SPECIAL

※ Customized-special production for user's condition

